

TORNADO & TURBO MIRRORS

Mounting Instructions
(Manual & Electric Models)

Wiring Tips

- 1) (Fig. 1) Position mirror for best visibility and mark location. Drill (2) 11/32" mounting holes (a 3rd hole is required for electric models only).
- 2) (Fig. 2) Insett the (2) plastic grommets in mounting holes. Place the base gasket and mounting bracket over the grommets making sure the gasket pointer and bracket groove are aligned. NOTE: On Tornado models this alignment will face to rear on driver side and to the front on passenger side. On Turbo models the alignment is to the rear (both sides). Secure hardware with (2) mounting screws.
- 3) (Fig. 3) Place mirror base over hardware and tighten set screw in the mirror base.

- 1) Drill a 11/32" wiring opening (Fig. 1)
- 2) Position mounting bracket and base gasket on mirror wires (Fig. 2) and draw them thru door with wire snake. Secure hardware and mirror to door (Fig. 2/3).
- 3) Attach wiring harness to mirror with butt connectors (Color to Color).
- 4) Locate switch conveniently (req. 7/8" opening).
- 5) #823-S Single Control Switch:
Connect wiring harness to switch (color to color) as shown (Fig. 4). Ground B/W pigtail to metal and tape all exposed connections. Attach Blue/Wh. wire to positive side of accessory fuse block. (8AMP) fuse is recommended (not supplied).
- 6) #824-DS Dual Control Switch:
Connect left wiring harness to switch as shown (Fig. 5). Remove approx. 4" of rubber shield from harness to expose wiring for splicing.
- 7) Remove the (3) female quick connects from the right side harness Y/Y/Blue. Connect the red wire to the B/R switch wire and splice the remaining (3) wires to the corresponding colored wires of the left harness. (Fig. 6) Ground the B/W pigtail to metal. Tape all exposed connections.
- 8) Attach Blue/W wire to a (positive) power source. An (8 AMP) in line fuse is recommended (not supplied).

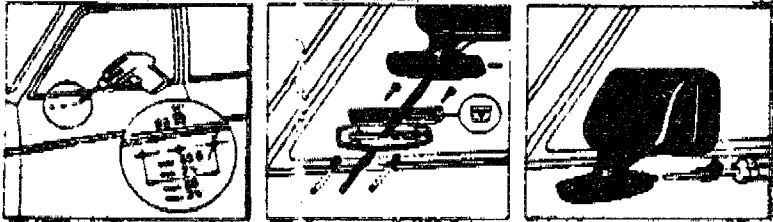

(Fig. 4)

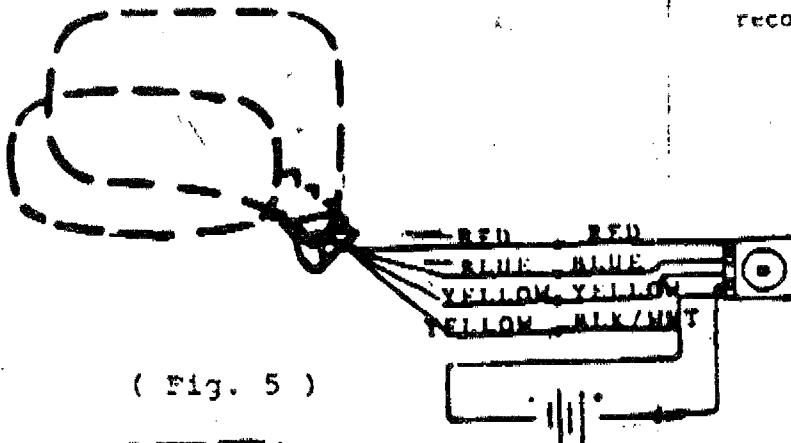

(Fig. 5)

Dual Control Switch
824-DS

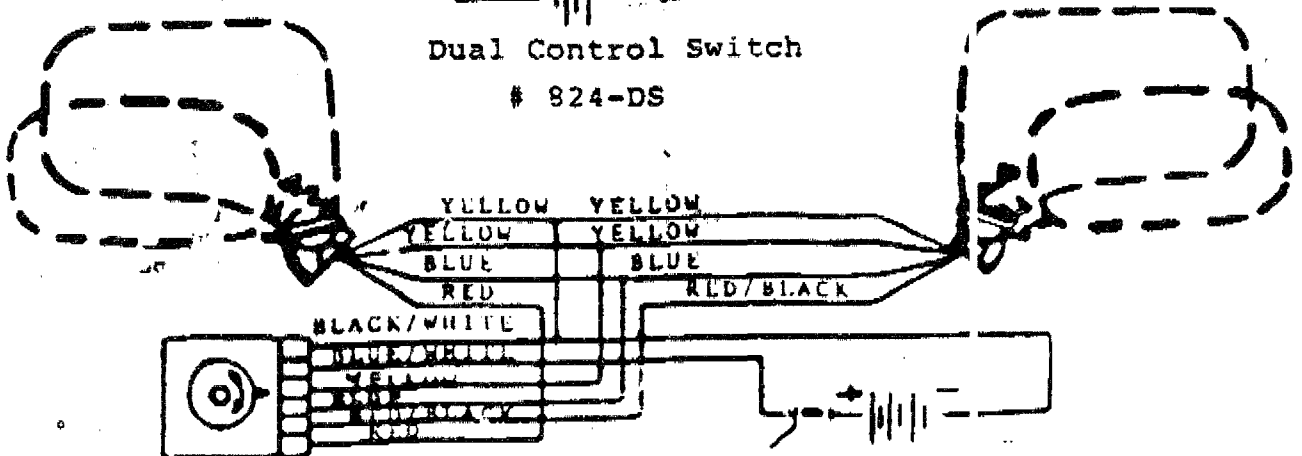

----- Single Control
Switch
923-S